

Tank Leak – Fill Valve Hose Position

Tank Leakage from Hose Siphoning

- An uncommon source of tank leakage can be due to incorrect positioning of the fill valve hose.
- If the end of the hose sits below the waterline in the toilet tank, then water can siphon into the hose, through the fill valve, and into the bowl.
- Siphonage through the fill valve hose would be slow, perhaps one drop of water every 3 seconds.
- The slow leak is not quickly noticed, but results in the fill valve turning on as frequently as every 15 to 30 minutes.

Hose Position – Non-Canister Models

Incorrect (Unsecured Hose)



Correct (Hose Secured with Clip)

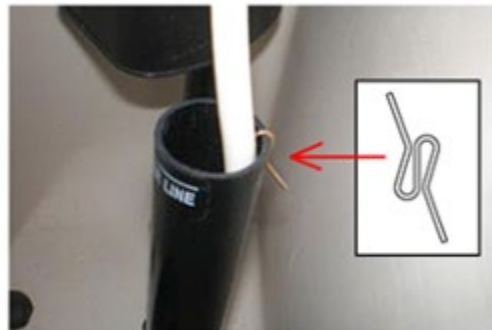

Hose Position – Canister Models

Incorrect (Detached Hose)



Correct (Hose Attached to Valve)

